

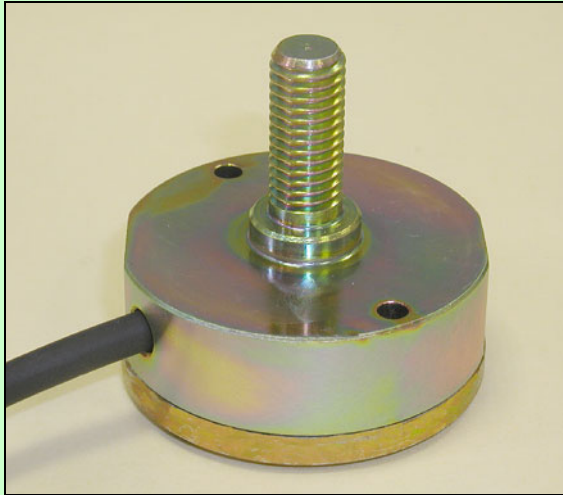

# Transducers for aerial platforms

## TCR Series



### Description

The transducers in the TCR series are normally used to measure the load in an basket/work platform cage. They are made of steel. Special finishes and materials are available on request.

**Note: The user/installer is responsible for evaluating the values and, thus, the safety of the application.**

### Technical data

Maximum power supply	7	Vdc
Nominal load	350÷1000	daN
Standard sensitivity	1.8 to 2.0	mV/V
Linearity, repeatability, hysteresis	± 1	%FS
FS and zero temperature coeff.	0.05	%FS
Insulation	> 5	GΩ
Input and output resistance	350	Ω
Decalibration overload	150	%
Operating temperature	-20 to 70	°C
Standard protection grade	IP 66	-

### Dimensions [mm]

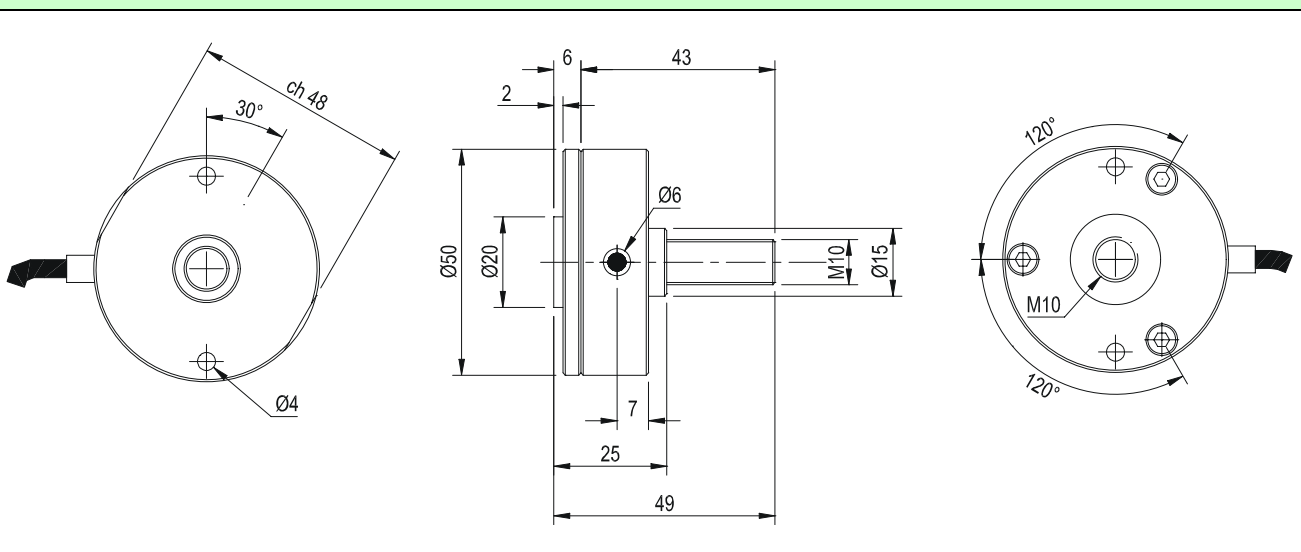

It is prohibited to use this apparatus/accessory until the machine onto which it is mounted has been declared in conformity with the Machine Directive 98/37/EEC.

BPE Electronics Srl should modify technical datas without advise

TRC v.1.06 2006